

pradovent trim

installation

tech specs

type	supply or extraction
air flow	supply max. 75m³/h
	extraction max. 50m³/h
pressure	5 - 85 Pa
noise level	< 27 dB(A)
adjustment	34 steps
color	white - RAL 9003
paintable	with synthetic primer
compatibility	fits into every Ø125 duct
other	patent pending

capacity graphs

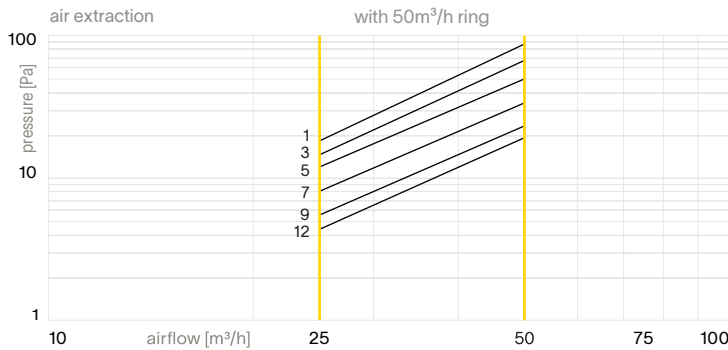
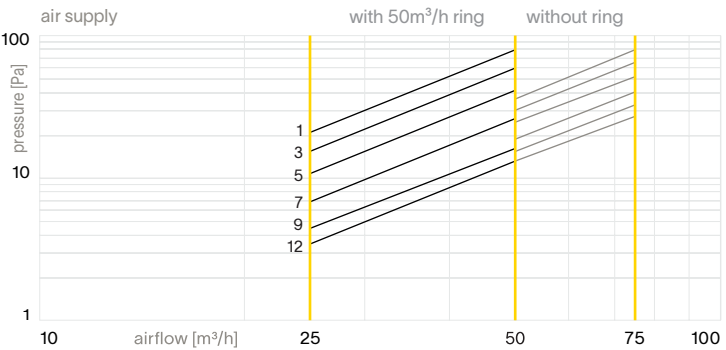

pradovent trim Ø125

installation instruction

1

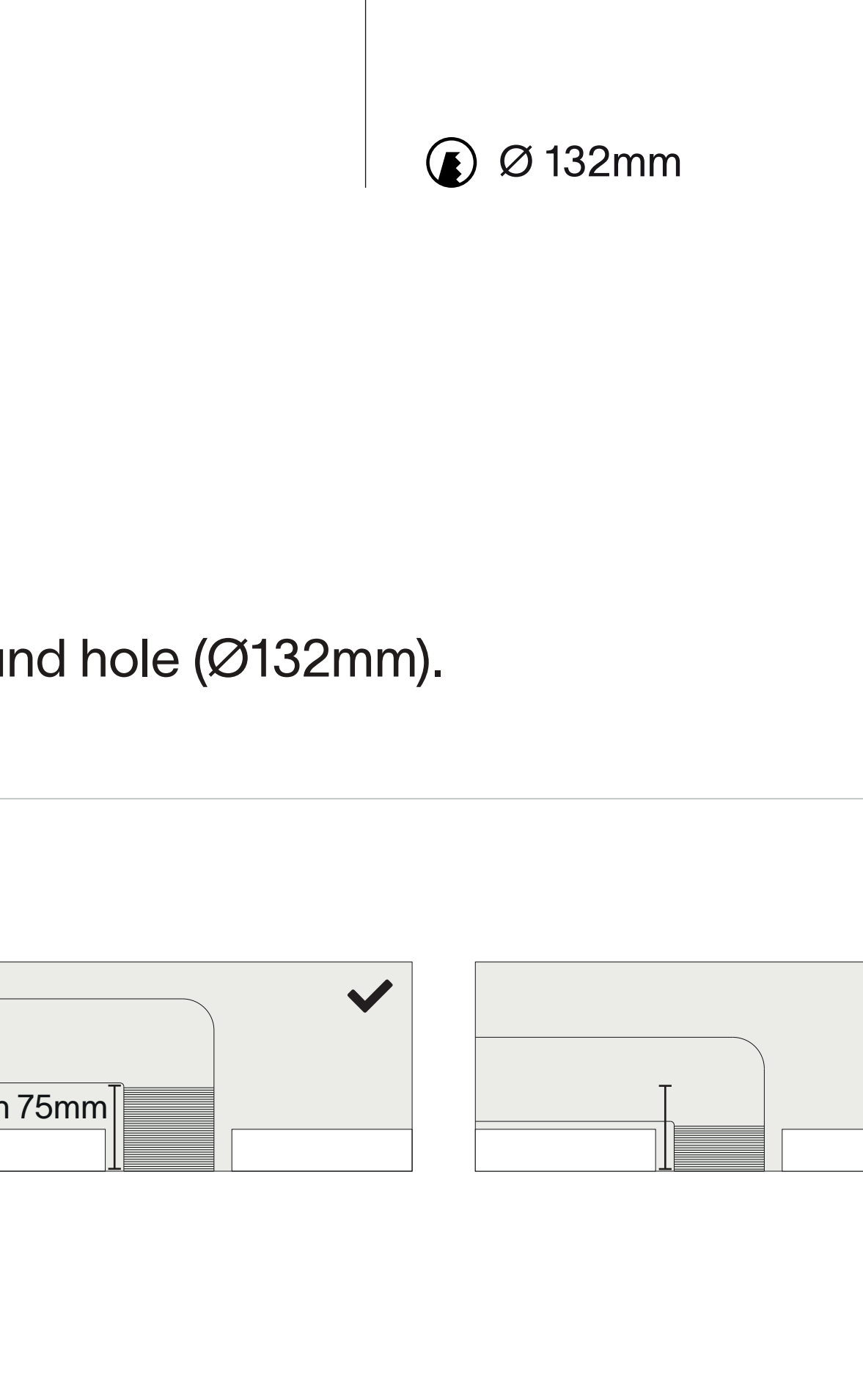

Cut a round hole (Ø132mm).

2

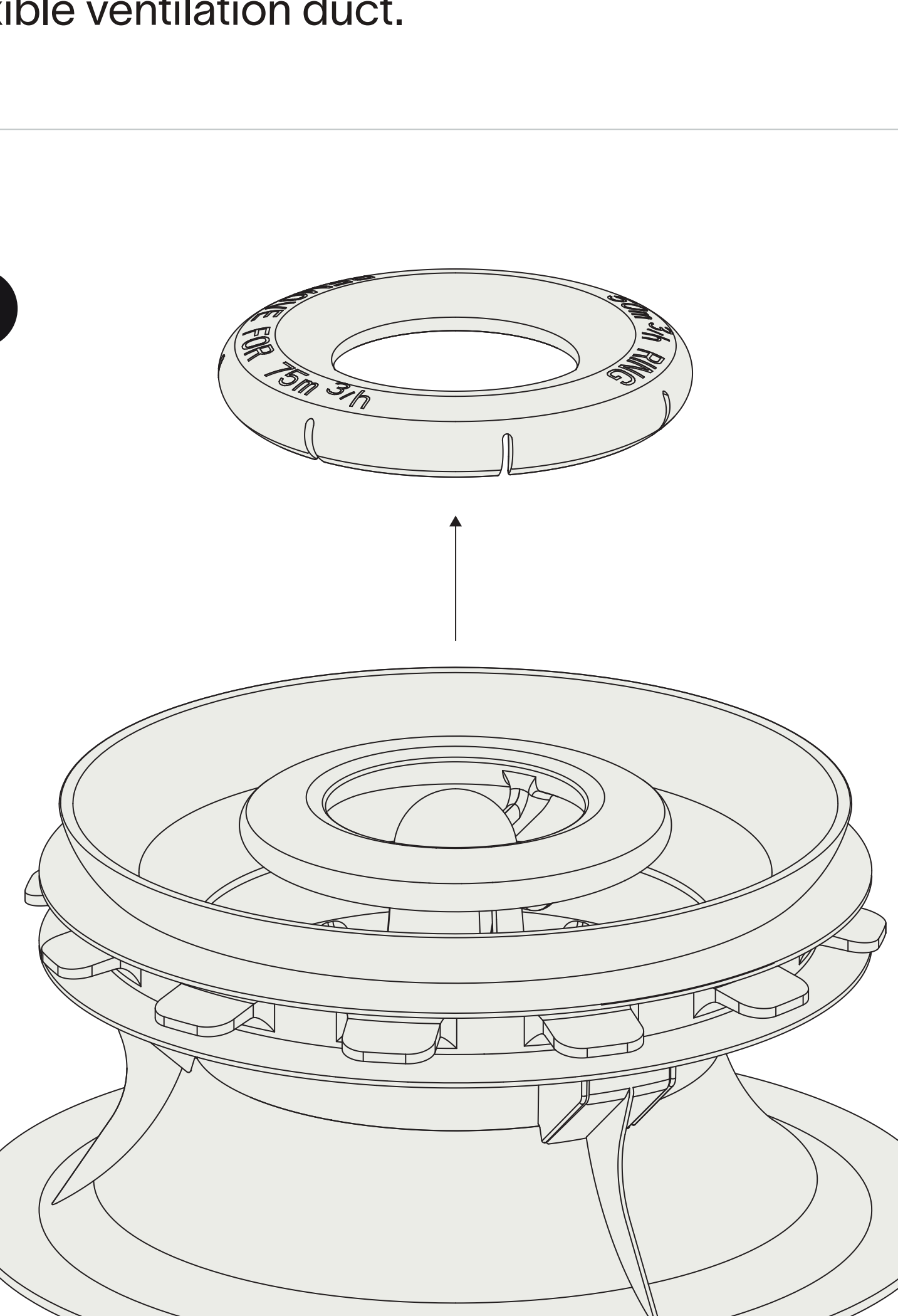

Cut off the excess length of the valve adapter.
(between 0 and 25 mm above final ceiling level)
The remaining vertical part of the adapter (before the start of the turn) must be at least 75 mm high for the ventilation valve. The valve is not compatible with a flexible ventilation duct.

3

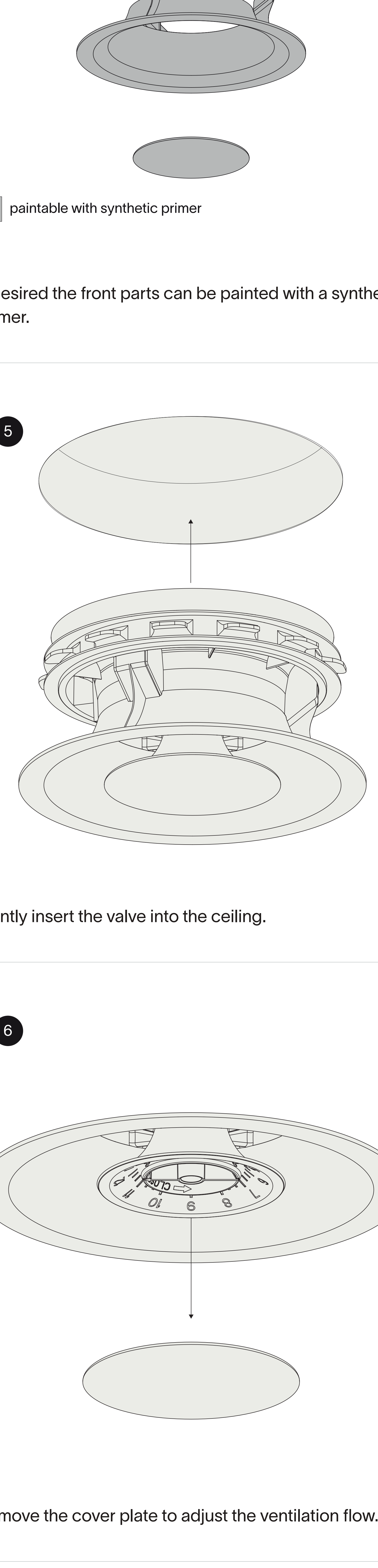

If 75m³/h is required (supply only)

Remove the 50m³/h ring.

If 50m³/h is required (supply & extraction)

Do not remove the 50m³/h ring.

4

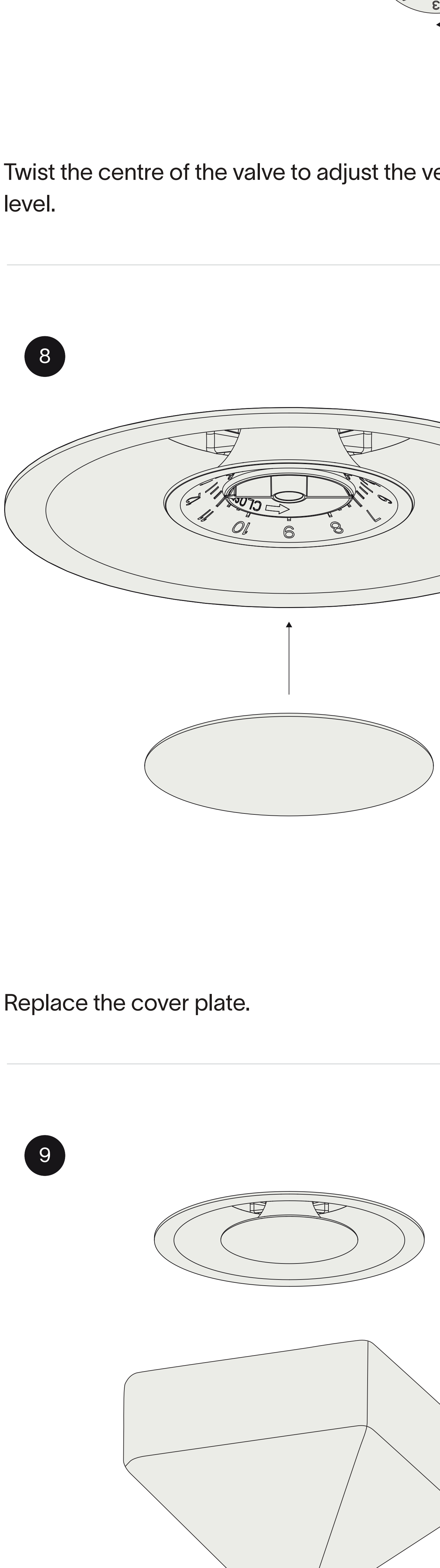

If desired the front parts can be painted with a synthetic primer.

5

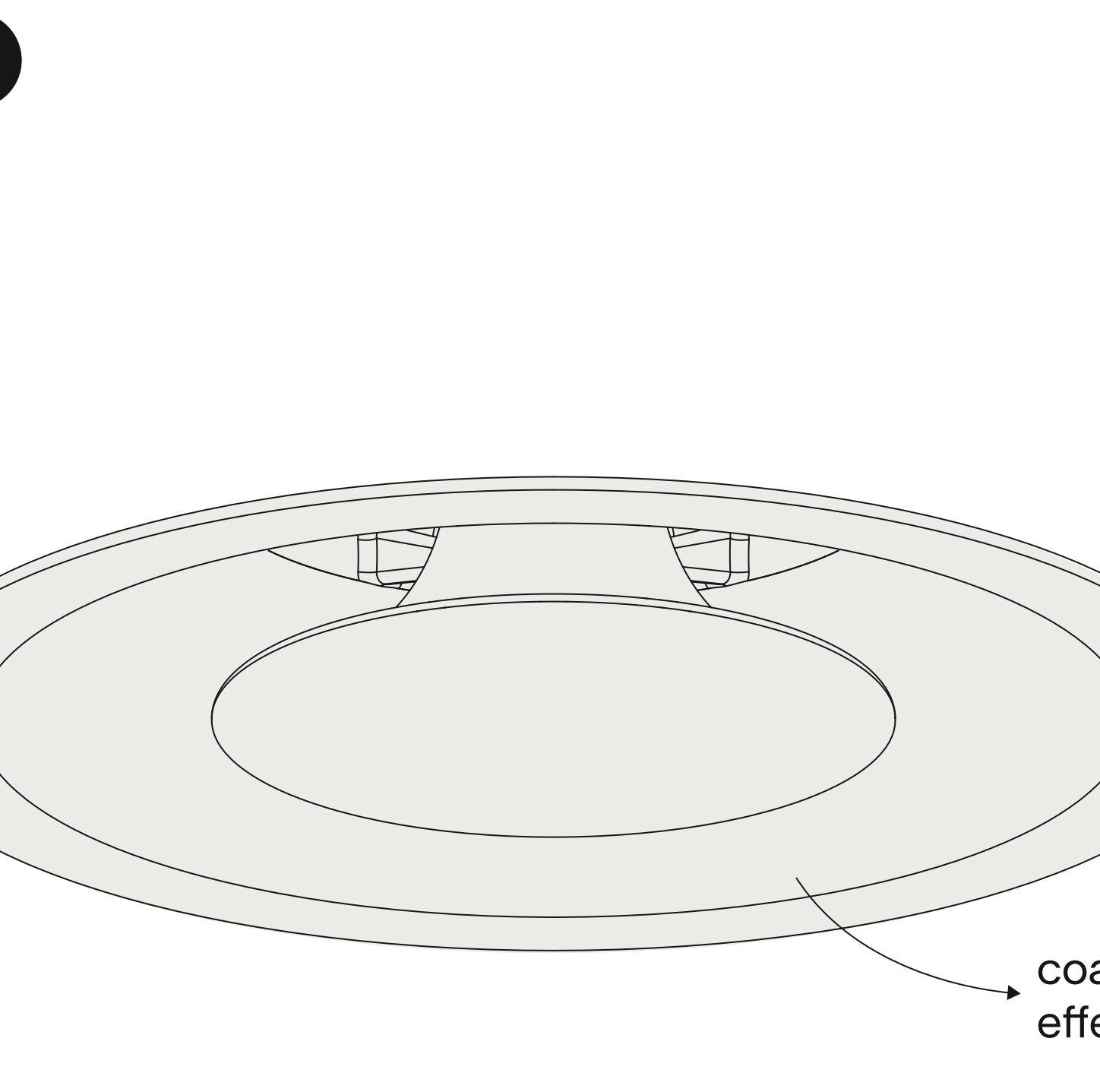

Gently insert the valve into the ceiling.

6

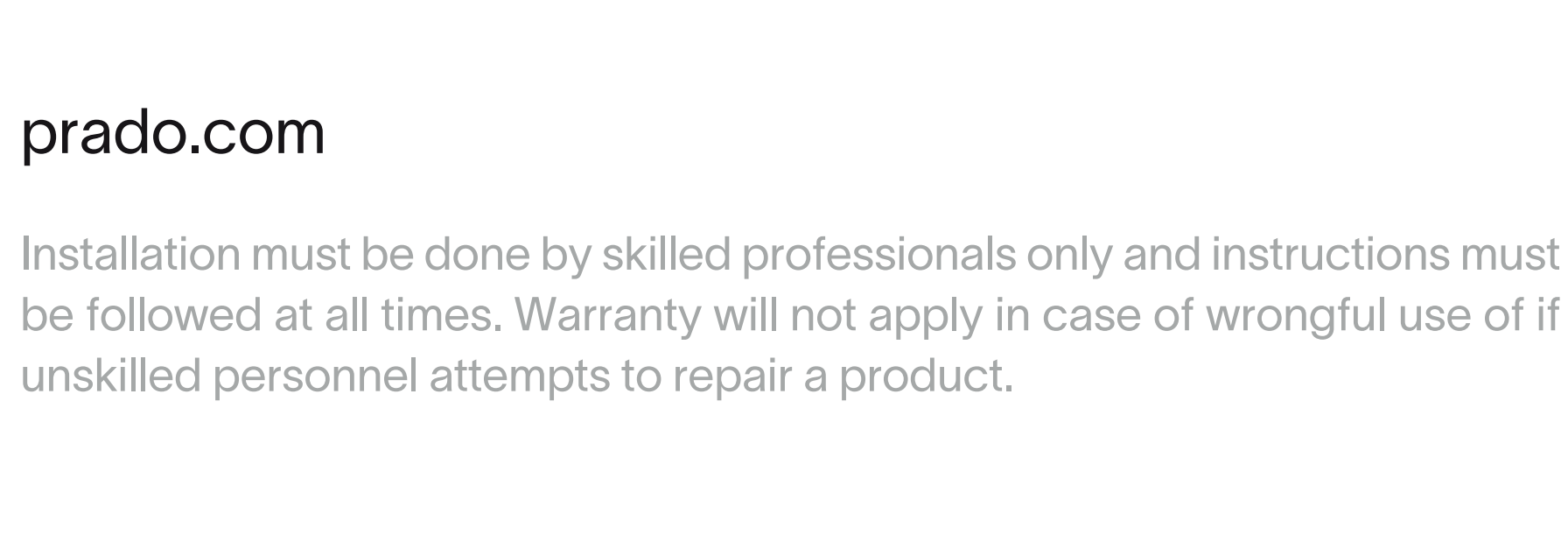

Remove the cover plate to adjust the ventilation flow.

7

Twist the centre of the valve to adjust the ventilation flow level.

8

Replace the cover plate.

9

Measure the ventilation flow with the cover plate on the valve and repeat step 6 to 8 until the desired flow is reached.

10

Maintenance: clean and replace the filters of your ventilation system regularly to keep your ceiling clean.
Thank you for choosing prado.