

adjustable plaster ring Ø108

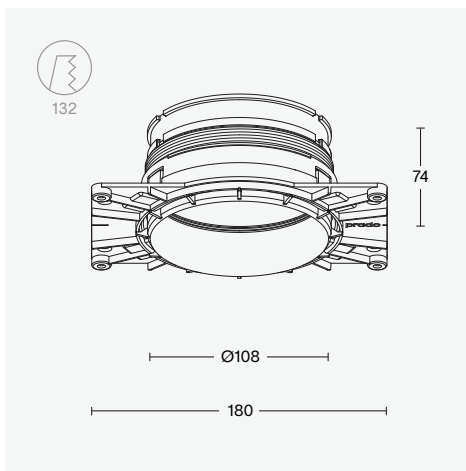
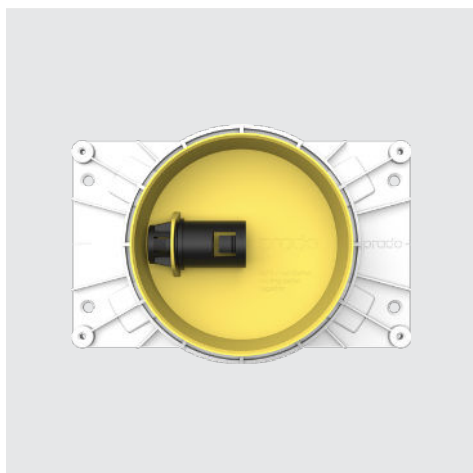

tech specs

kit size 180 x 128 x 74 (l x w x h)

cut-out size Ø 132 h 80

adjustability min. 12mm - max. 33mm

ventilation specs fits into every Ø125 valve adapter

location ceiling indoor

order number

8000 - 0101 adjustable plaster ring Ø108

alternatives

8000 - 0001 plaster ring Ø108

8000 - 0011 clt csc ring Ø108

adjustable plaster ring Ø108

installation instruction

1

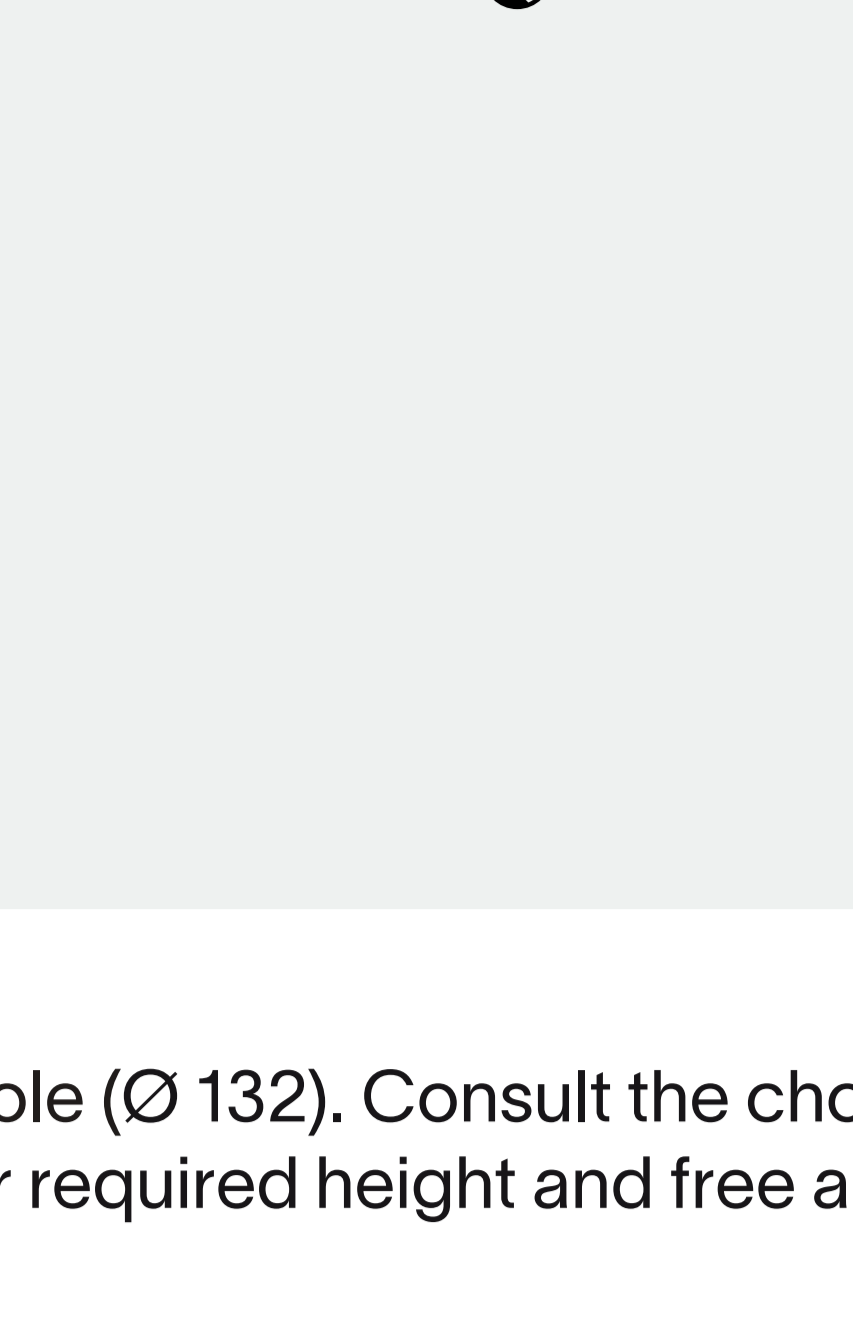

Cut a round hole (Ø 132). Consult the chosen luminaire tech specs for required height and free air dimensions.

2

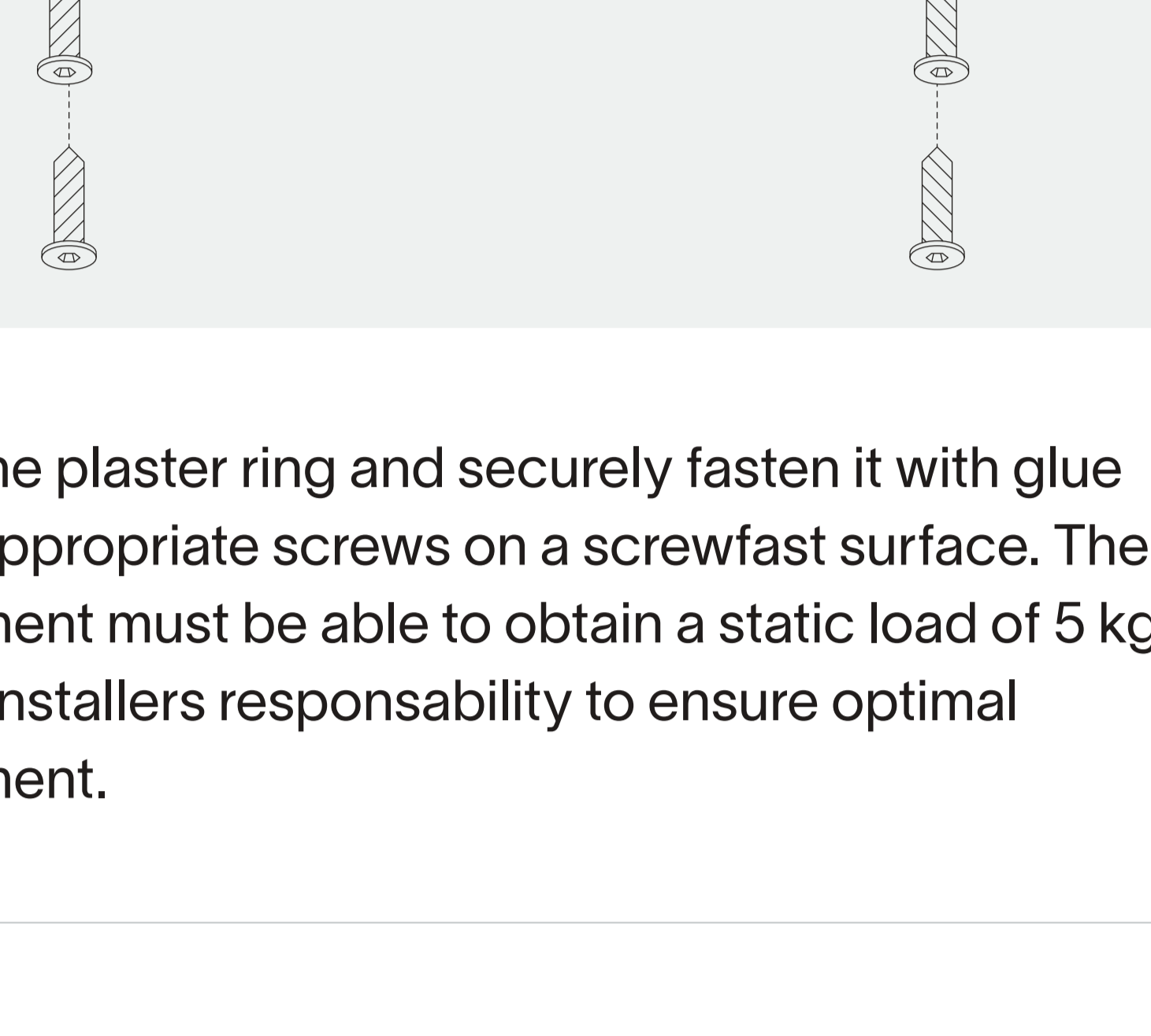

Insert the plaster ring and securely fasten it with glue or the appropriate screws on a screwfast surface. The attachment must be able to obtain a static load of 5 kg. It's the installers responsibility to ensure optimal attachment.

or

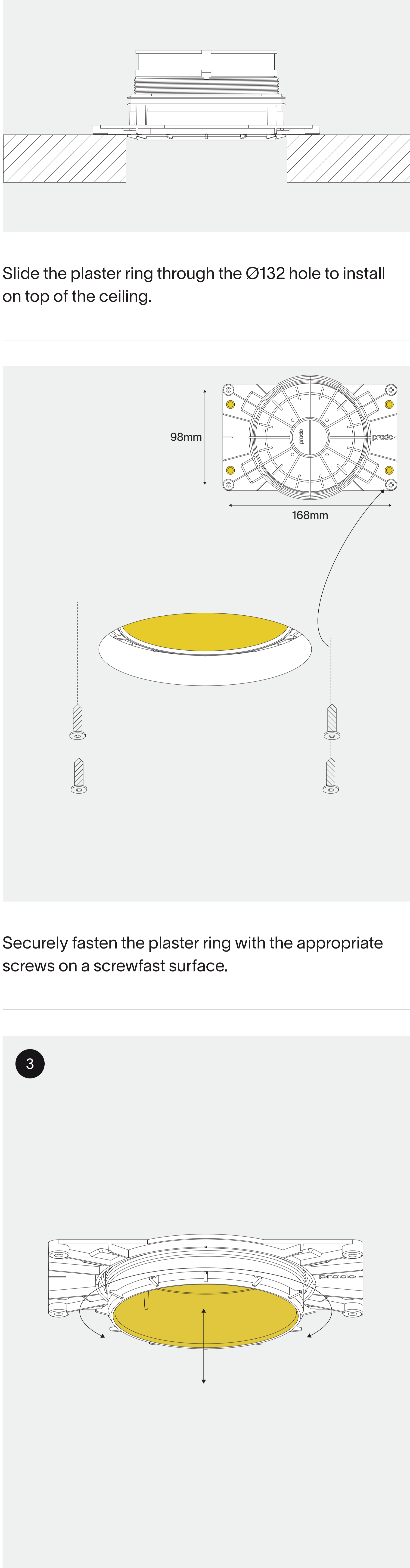

Slide the plaster ring through the Ø132 hole to install on top of the ceiling.

Securely fasten the plaster ring with the appropriate screws on a screwfast surface.

3

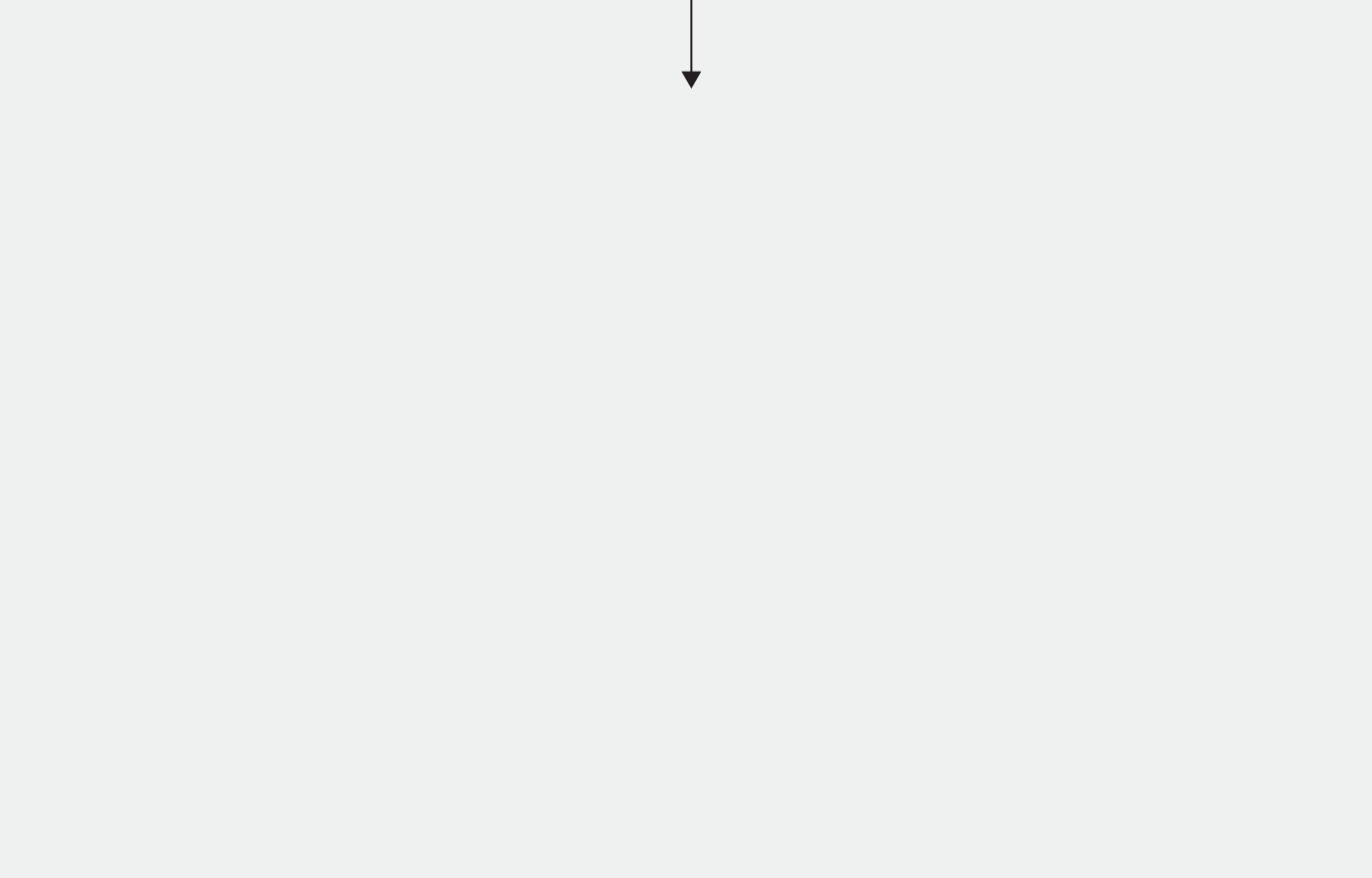

Adjust the height of the plaster ring by twisting the bottom part.

4

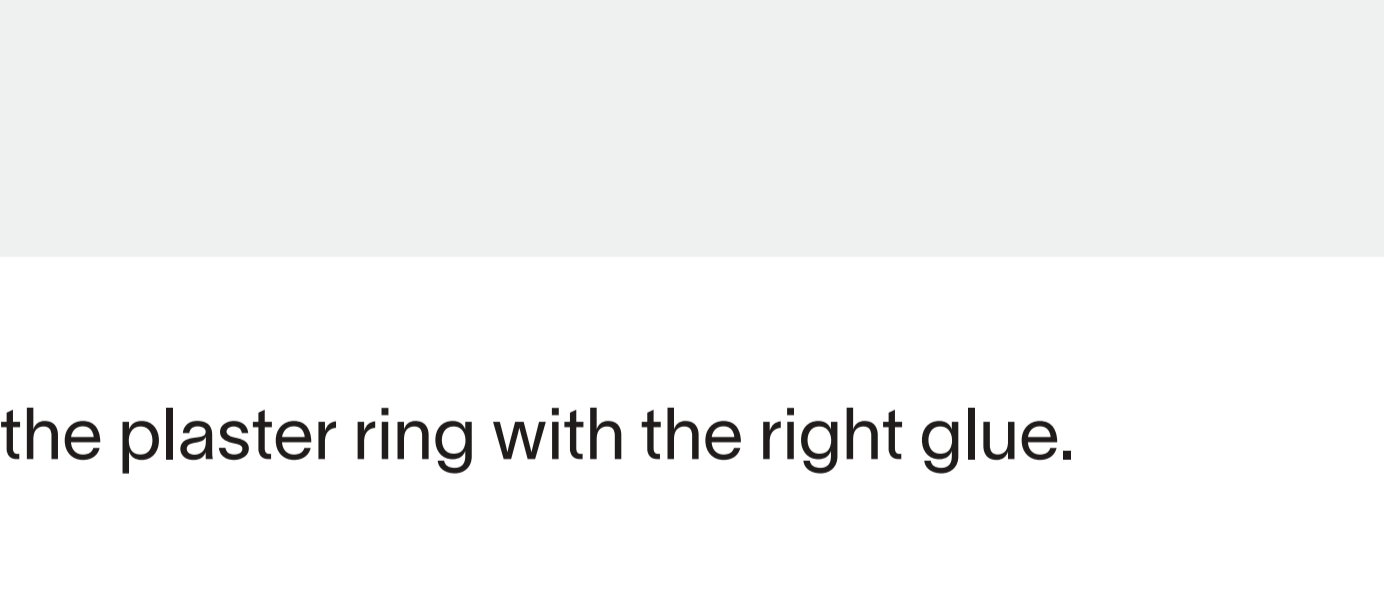

Lock the plaster ring with the right glue.

5

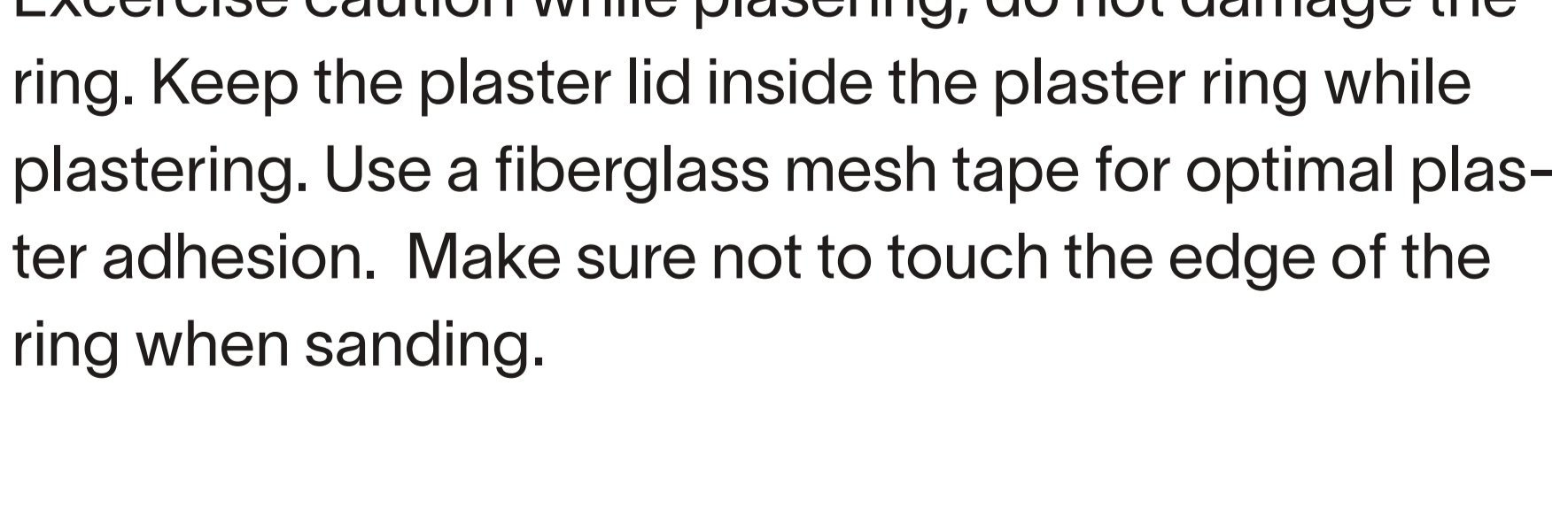
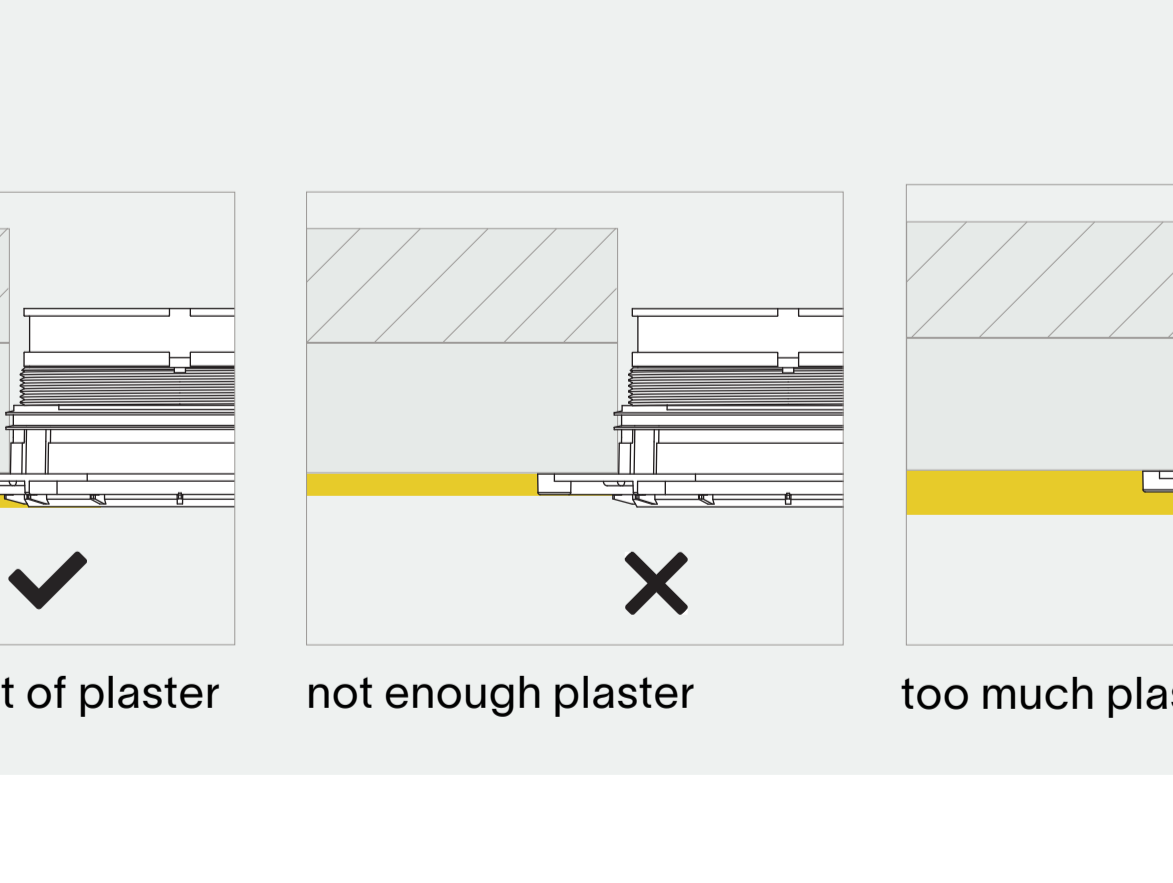

perfect amount of plaster

not enough plaster

too much plaster

Excercise caution while plastering, do not damage the ring. Keep the plaster lid inside the plaster ring while plastering. Use a fiberglass mesh tape for optimal plaster adhesion. Make sure not to touch the edge of the ring when sanding.

6

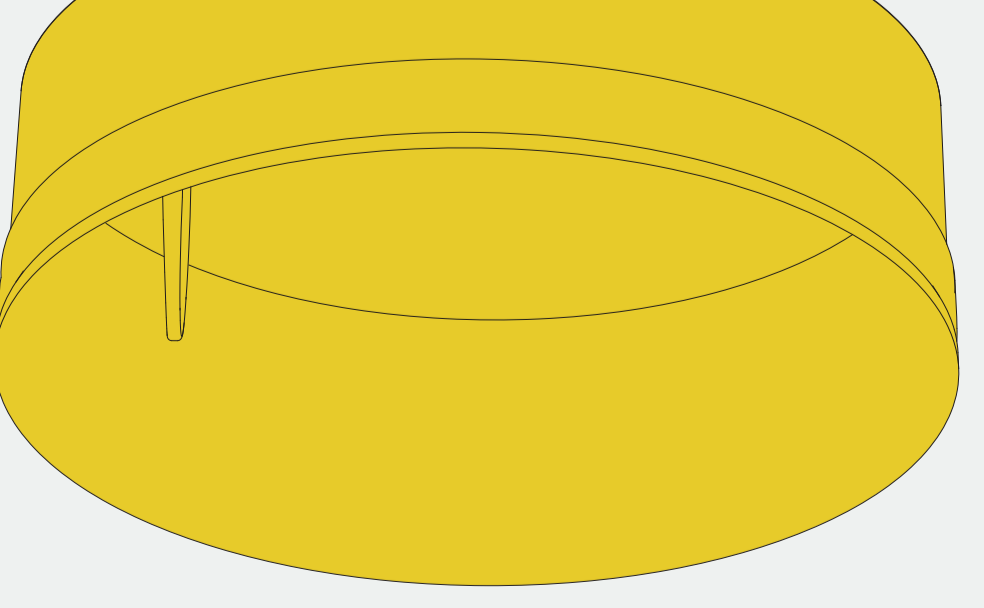

remove the yellow lid just before installing the fixture

thank you for choosing prado